



HVHZ
PLASTPRO INC.

DESIGNATED IMPACT ZONES

Plastpro High Velocity Hurricane Zone (HVHZ) Impact Doors are engineered to withstand penetration of flying objects while maintaining all of the benefits and beauty of our door panel curb appeal. Our innovative R&D Department has pioneered a unique patent-pending process whereby a missile-proof shield is built-in to reinforce the door.

THE DOOR OF BEAUTY AND INNOVATION



□ **Non-Impact Zones**

Winds below 140 mph

■ **Wind Borne Debris Regions (WBDR)**

Regions where the average speed of wind is 140 mph or greater

■ **High Velocity Hurricane Zone (HVHZ)**

HVHZ in Dade and Broward Counties in Florida



HVHZ IMPACT DOORS

HVHZ IMPACT DOORS

MODERN DOORS

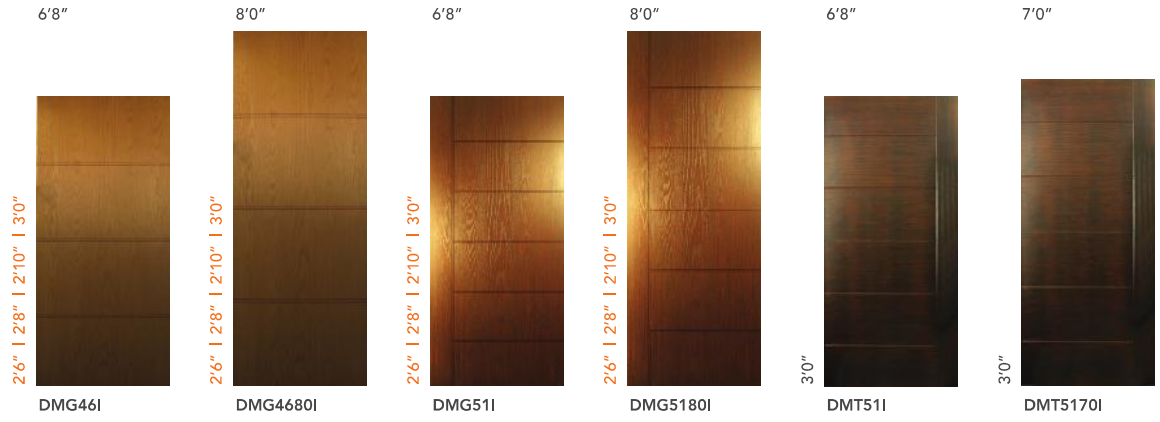

CHERRY DOORS



RUSTIC DOORS





MAHOGANY DOORS

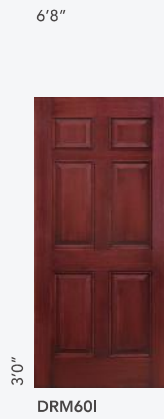
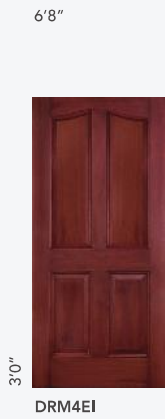
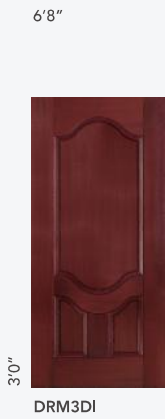

OAK DOORS

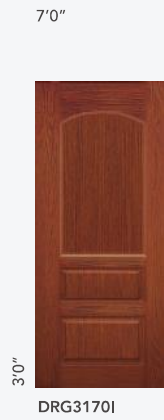
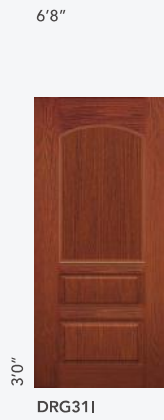
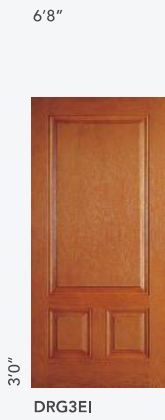

HVHZ IMPACT DOORS

HVHZ IMPACT DOORS

OAK DOORS



DRG40I 6'8" 2'6" | 2'8" | 2'10" | 3'0"
 DRG41I 6'8" 2'8" | 2'10" | 3'0"
 DRG4170I 7'0" 2'8" | 2'10" | 3'0"
 DRG4180I 8'0" 2'8" | 2'10" | 3'0"
 DRG6BI 6'8" 2'8" | 2'10" | 3'0"
 DRG6CI 6'8" 3'0"



DRG60I 6'8" 2'6" | 3'0"
 DRG6080I 8'0" 2'6" | 2'8" | 3'0" | 3'6"
 DRG6170I 7'0" 2'8" | 2'10" | 3'0"
 DRG63I 6'8" 2'8" | 2'10" | 3'0"
 DRG80I 6'8" 3'0"
 DRG8080I 8'0" 3'0" | 3'6"



DRG90I 6'8" 2'8" | 3'0"
 DRG9180I 8'0" 3'0"

SMOOTH DOORS



DR500I 6'8" 2'0" | 2'4" | 2'6" | 2'8" | 2'10" | 3'0"
 DR50070I 7'0" 2'0" | 2'4" | 2'6" | 2'8" | 2'10" | 3'0"
 DR50080I 8'0" 2'0" | 2'4" | 2'6" | 2'8" | 2'10" | 3'0"
 DR52BI 6'8" 2'6" | 2'8" | 3'0"
 DR52B80I 8'0" 2'6" | 2'8" | 3'0"
 DR52DI 6'8" 2'6" | 2'8" | 3'0"

HVHZ IMPACT



SMOOTH DOORS



WHITE OAK DOORS

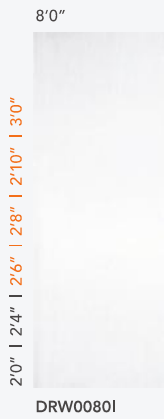

ONELITE DOORS





PRE-FINISH KIT & STAINING GUIDES

Plastpro pre-finish Stain Kit increase protection and durability to your Plastpro fiberglass entry door.

Faster drying time with environmental friendly water based top coat. Special formula with long lasting vibrant colors. Easy do-it-yourself use as well as for professional painters.

Design exclusively for Plastpro fiberglass entry door.



PRE-FINISH KIT

Plastpro's Pre-Finish Staining Kit contains everything you need to stain one prehung door and two sidelites, or one double door unit.

BENEFITS & ADVANTAGES

- Increased protection and durability to your plastpro fiberglass entry door
- Faster drying time with environmental friendly water based top coat
- Special formula with long lasting vibrant colors
- Easy to apply
- Designed exclusively for plastpro fiberglass entry doors

BOX CONTAINS

- | | |
|---|------------------------------|
| ■ Zar® Exterior Water-Based Polyurethane (qt) | ■ Cheese Cloths |
| ■ Zar® Wood Stain (pt) | ■ Two Stir Sticks |
| ■ Mineral Spirits (4 oz.) | ■ One Pair of Latex Gloves |
| ■ Two 2" Foam Brushes | ■ Door Staining Instructions |
| ■ One 2.5" Synthetic Bristle Brush | ■ Two Skin Samples |



STAIN COLOR OPTIONS

You can control the shade (lighter or darker) of each of the 7 stain colors during application by varying the amount of stain applied. *Actual stain color may vary. For best result, test on skin sample first.

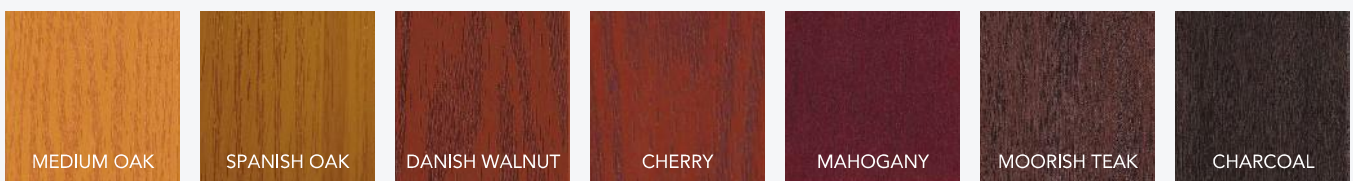

MEDIUM OAK

SPANISH OAK

DANISH WALNUT

CHERRY

MAHOGANY

MOORISH TEAK

CHARCOAL

WOODGRAIN

MATERIALS NEEDED

PLASTPRO'S PRE-FINISH KIT OR:

- | | |
|---------------------------------|---------------------------|
| A. Pre-Mixed Stain (1/2 pint) | F. 3" China Bristle Brush |
| B. Mineral Spirits (4 fl. oz.) | G. Two Stir Sticks |
| C. Top Coat/Sealer (20 fl. oz.) | H. Two Skin Samples |
| D. Two Clean Cloth | I. Finishing Instruction |
| E. One Pair Protective Gloves | |

STAINING INSTRUCTIONS FOR GRAINED DOORS & PF™ DOOR FRAMES



STEP 1: SURFACE PREPARATION

1. Lay door horizontally on saw horses or a table.
2. Remove all the hardware and mask off anything you don't want stained such as the glass insert.
3. DO NOT SAND GRAINED FIBERGLASS / PF™ DOOR FRAMES
4. Wipe the Door / PF™ Door Frame with mineral spirits to clean any dust or residue from the surface. Allow door surface to dry completely before applying stain.



STEP 2: STAIN APPLICATION

1. Starting at the center of the Door / PF™ Door Frame, stain one to two panels at a time. Apply stain with a 3" to 4" soft bristle brush, or rag. Apply enough stain to fill the Door / PF™ Door Frame grain.
2. With a clean, lint free 24" x 24" cloth, softly wipe the surface until you reach your desired tone. TIP: When the rag becomes saturated with stain, refold to work with a less saturated section. Be sure to use the same rag for the whole Door / PF™ Door Frame.
3. After all stain is brushed evenly, you may add finishing touches by using a small 1" to 2" brush or cotton swabs.
4. (If desired) Allow the Door / PF™ Door Frame to dry for at least 48 hours before applying another coat. Then, repeat above process.



STEP 3: PROTECTIVE TOP COAT

Application of polyurethane top coat with UV inhibitors like ZAR™ Exterior polyurethane, Wood Kote® Flagship UV, or Minwax® Fast Drying Polyurethane for exterior applications.

1. After stain has completely dried (48 hours), mix the top coat well and apply evenly using a clean dry 2" soft bristle brush or 3" foam brush. Be sure to stop when the grain changes direction.
2. Apply two or three coats of finish, allowing at least 24 hours of drying time between each application.



IMPORTANT TO NOTE:

- It is considered normal maintenance to re-apply the topcoat approximately every two years. Even a well-finished fiberglass door will be affected by exposure and weathering from sun, moisture, and air pollutants.
- Staining instructions are for Oil-Based, Premium Quality Wood Stains or similar product designed for use on a fiberglass surface. Please note the instructions indicated are specific to the Zar brand stain included in our stain kit. Please reference stain manufacturers instructions before applying any stain.

PAINTING GUIDES

WOODGRAIN

MATERIALS NEEDED

- A. Lint-free cloth
- B. Mineral Spirits
- C. Rubber gloves
- D. Masking tape
- E. 4" Bristle Brush
- F. For Water-based Application: Acrylic-based primer*/ acrylic latex-based exterior grade paint.

We recommend using Sherwin-Williams PrepRite® Bonding Primer with compatible acrylic-latex paint for optimal paint adhesion.

PAINTING INSTRUCTIONS FOR OAK GRAIN DOORS



STEP 1: SURFACE PREPARATION

1. Lay door horizontally on saw horses or a table.
2. Remove all the hardware and mask off anything you don't want painted, such as the glass insert.
3. DO NOT SAND GRAINED FIBERGLASS.
4. Wipe the door with mineral spirits to clean any dust or residue from the surface. Allow door surface to dry completely before applying stain paint. Do not use hydro-carbon based solvents to clean the surface as such products may leave a residue.
5. Apply primer with a 4" brush beginning with the panels. Follow the manufacturer's instructions for drying time before applying topcoat. Continue to apply the primer to ALL 6 sides. Doors which have been bored and mortised for hardware should be primed inside of the lock bore as well.
6. The primer must be completely dry before applying the topcoat.



STEP 2: PAINTING

1. Apply exterior grade paint with 4" brush beginning with the panels.
2. It is common practice to paint both stiles the same color as the exterior side of the door. If applying a second coat, follow the manufacturer's instructions for drying time between coats.
3. Continue to apply the top coat to ALL 6 sides of the door which have been bored and mortised for hardware should be finished inside of the lock bore as well.

CAUTION

1. When using stains, mineral spirits, paints, or other hazardous materials, always read and follow the manufacturer's instructions. Plastpro, Inc. makes no representations as to the proper use of other manufacturers' products.
2. When working with paints or solvents, make sure the working area is well ventilated.
3. Keep away from heat and flame as materials may be combustible.
4. Paints or solvents may cause skin and eye irritation. Avoid contact with skin and eyes.
5. Keep out of reach of children.

IMPORTANT TO NOTE:

- It is considered normal maintenance to re-apply the topcoat approximately every two years. Even a well-finished fiberglass door will be affected by exposure and weathering from sun, moisture, and air pollutants.

SMOOTH SKIN

MATERIALS NEEDED

- A. Lint-free Cloth
- B. Mineral Spirits
- C. Rubber Gloves
- D. Masking Tape
- E. 4" Bristle Brush

- F. For Water-based Application: Acrylic-based primer* / acrylic latex-based exterior grade paint.
- G. Scotch Brite Pad (Fine) or 320-400 grit sandpaper (For Smooth Doors Only)

We recommend using Sherwin-Williams PrepRite® Bonding Primer with compatible acrylic-latex paint for optimal paint adhesion.

PAINTING INSTRUCTIONS FOR DOORS & PFT™ DOOR FRAMES

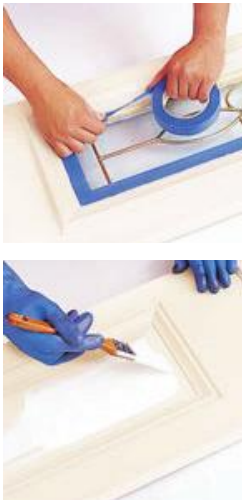

STEP 1: SURFACE PREPARATION

1. Lay door horizontally on saw horses or a table.
2. Remove all the hardware and mask off anything you don't want painted, such as the glass insert.
3. **Smooth Doors only.** Lightly scuff sand the surface with a Scotch Brite pad or fine sand paper. **DO NOT SAND GRAINED FIBERGLASS.**
4. Wipe the door with mineral spirits to clean any dust or residue from the surface. Allow acetone to dry from the surface before applying.
5. Do not use hydro-carbon based solvents to clean the surface as such products may leave a residue.
6. Apply primer with a 4" brush beginning with the panels. Follow the manufacturer's instructions for drying time before applying topcoat. Continue to apply the prime to ALL 6 sides. Doors / PFT™ Door Frames which have been bored and mortised, or machined for hardware should be primed inside of the lock bore, or prepped area as well.
7. The primer must be completely dry before applying the topcoat.



STEP 2: PAINTING

1. Apply exterior grade paint with 4" brush beginning with the panels.
2. It is a common practice to paint both door stiles, or both PFT™ Door Frame sides, the same color as the exterior side of the door. If applying a second coat, follow the manufacturer's instructions for drying time between coats.
3. Continue to apply the top coat to ALL 6 sides of the door which have been bored and mortised for hardware should be finished inside of the lock bore as well.

CAUTION

1. When using stains, mineral spirits, paints, or other hazardous materials, always read and follow the manufacturer's instructions. Plastpro Inc. makes no representations as to the proper use of other manufacturers' products.
2. When working with paints or solvents, make sure the working area is well ventilated.
3. Keep away from heat and flame as materials may be combustible.
4. Paints or solvents may cause skin and eye irritation. Avoid contact with skin and eyes.
5. Keep out of reach of children.

IMPORTANT TO NOTE:

- It is considered normal maintenance to re-apply the topcoat approximately every two years. Even a well-finished fiberglass door will be affected by exposure and weathering from sun, moisture, and air pollutants.